

>> ROTARY DIVERT VALVE (2/3-TDV)

>> FEATURES:

- Available with 2 or 3 ports
- Smooth product contact surfaces
- Inflatable seals
- Pressure from 23" Hg up to 45 PSIG
- Multiple choice of line connections
- Minimized product degradation
- Converging and diverging applications
- Easy detachable construction
- Temperature range – 5°F up to +212°F
- All stainless and aluminum stainless configurations
- Versions conforming to ATEX 94/9/EC available

2/3 Tube Diverter Valves

Contrary to the M-TDV multi-port tube diverter valve, which has an electric drive and up to 14 in/outlets, both the new 2- and 3-TDV (tube diverter valves) are activated using a pneumatic actua-

tor due to cost considerations. This gives a very compact design to both diverters and by using an additional line cylinder on the 3-TDV very accurate positioning is achieved.

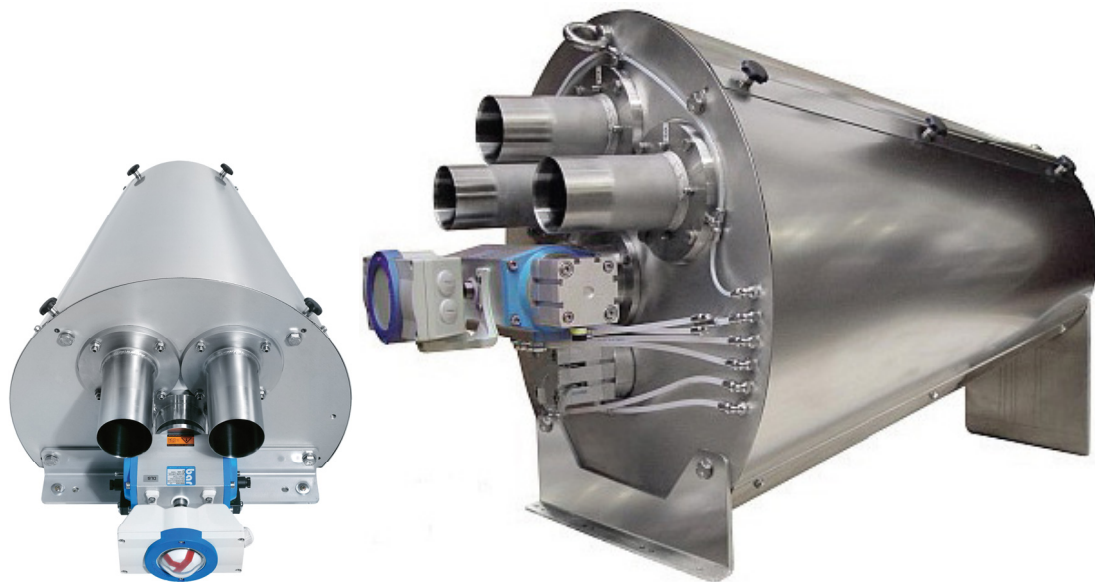

Product Information

The uniquely designed seal that has already been proved on the M-TDV is also being used on the new 2- and 3-TDV. This seal is made from white EPDM and is very easy to fit and clean, and being inflatable guarantees absolutely tight sealing in the conveying line up to 45 PSIG (higher upon request). This also applies to liquids.

The whole range of tube diverters (2-, 3-, and M-TDV) are of a sanitary design and have stainless steel AISI 316 product contact parts with multiple choices of line connections, ranging from a simple pipe connection to a tri-clamp fitting. The swan neck pipe connection the inlet to outlets is designed to give minimum product degradation

in both conveying directions. All conveying lines that are not in use are also sealed at the diverter outlet. This ensures that there is no air or product leakage from destinations that are not being used.

The diverters are designed to be easily removed from the line for cleaning (COP—clean out of place). It is also possible to purge the individual conveying lines with a cleaning liquid without removing the diverter from the line (CIP—clean in place). Removal from the line is only necessary when a complete cleaning operation is required. This gives the customer the option to choose a cleaning method tailored to suit their process.



Powder Process-Solutions
Div. of Powder-Solutions Group
1620 Lake Drive West
Chanhassen, MN 55317
Ph: 952-279-5205
Fax: 952-279-5206
sales@powder-solutions.com
www.powder-solutions.com

>> ROTARY DIVERT VALVE (2/3-TDV)

>> FEATURES:

- Available with 2 or 3 ports
- Smooth product contact surfaces
- Inflatable seals
- Pressure from 23" Hg up to 45 PSIG
- Multiple choice of line connections
- Minimized product degradation
- Converging and diverging applications
- Easy detachable construction
- Temperature range – 5°F up to +212°F
- All stainless and aluminum stainless configurations
- Versions conforming to ATEX 94/9/EC available

2-TDV

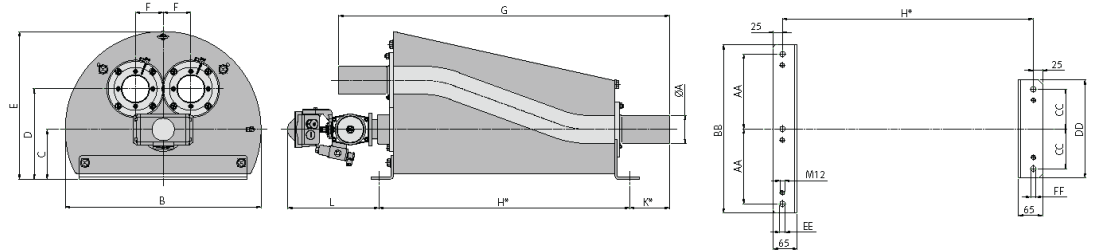

3-TDV

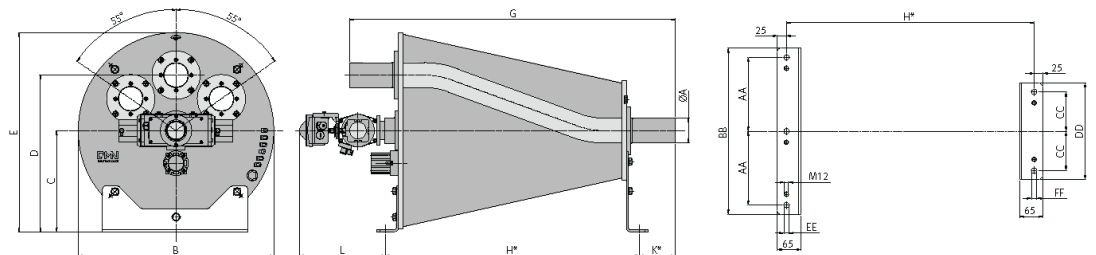

Type 2-TDV	ØA	B	C	D	E	F	G	Execution 2		Execution 3		L	AA	BB	CC	DD	EE	FF
								H	K	H	K							
40	38.1x1.5	490	130	235	375	65	806	590	108	576	115	247	187.5	425	107.5	265	3xØ14	2xØ14
50	50.8x1.5	490	130	235	375	65	806	590	108	576	115	247	187.5	425	107.5	265	3xØ14	2xØ14
65	63.5x1.5	530	135	245	400	75	896	680	108	666	115	255	202.5	455	107.5	265	3xØ14	2xØ14
80	76.1x1.5	530	135	245	400	75	896	680	108	666	115	255	202.5	455	107.5	265	3xØ14	2xØ14
100	101.6x2	600	165	287.5	465	87.5	946	730	108	716	115	255	230	510	130	310	3xØ14	2xØ14
125	129x2	695	175	325	522.5	102.5	1116	900	108	886	115	264	275	600	135	320	3xØ14	2xØ14
150	154x2	755	205	365	582.5	115	1156	940	108	926	115	264	295	640	150	350	3xØ14	2xØ14

Type 3-TDV	ØA	B	C	D	E	G	Execution 2		Execution 3		L	AA	BB	CC	DD	EE	FF
							H	K	H	K							
40	38.1x1.5	560	290	440	570	886	670	108	656	115	247	182.5	415	100	250	3xØ14	2xØ14
50	50.8x1.5	560	290	440	570	886	670	108	656	115	247	182.5	415	100	250	3xØ14	2xØ14
65	63.5x1.5	600	310	480	610	997	781	108	767	115	255	197.5	445	100	250	3xØ14	2xØ14
80	76.1x1.5	600	310	480	610	997	781	108	767	115	255	197.5	445	100	250	3xØ14	2xØ14
100	101.6x2	670	345	535	680	1054	838	108	824	115	255	210	470	115	280	3xØ14	2xØ14
125	129x2	770	395	620	780	1209	993	108	979	115	264	250	550	125	300	3xØ14	2xØ14
150	154x2	850	435	685	860	1269	1053	108	1039	115	264	277.5	605	132.5	315	3xØ14	2xØ14



Powder Process-Solutions
 Div. of Powder-Solutions Group
 1620 Lake Drive West
 Chanhassen, MN 55317
 Ph: 952-279-5205
 Fax: 952-279-5206
sales@powder-solutions.com
www.powder-solutions.com

Execution 2 = version with aluminium covers
 Execution 3 = version with stainless steel cover